

REMOVAL AND INSTALLATION

Exhaust Gas Recirculation Temperature (EGRT) Sensor — Inlet

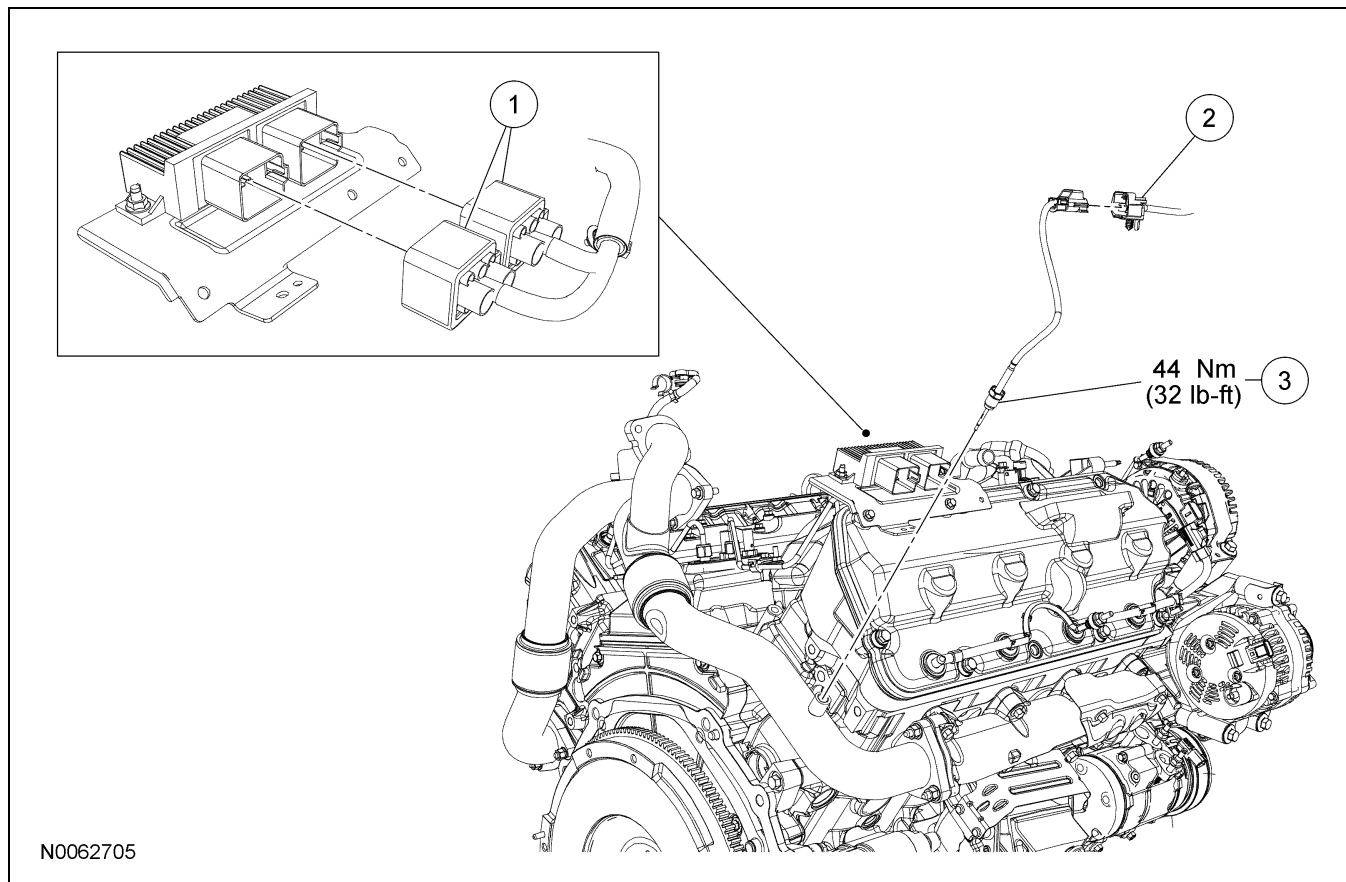

Item	Part Number	Description
1	14A464	Glow plug module electrical connectors (part of 12B637)
2	14A464	Inlet exhaust gas recirculation temperature (EGRT) sensor electrical connector
3	12B591	Inlet EGRT sensor

Removal and Installation

1. **CAUTION:** Make sure the ignition switch is in the OFF position prior to working on the electronic engine controls or the vehicle may be damaged.

Turn the ignition switch to the OFF position.

2. Remove the RH inner fender splash shield. For additional information, refer to Section 501-02.
3. Disconnect the glow plug module electrical connectors.
4. Disconnect the inlet exhaust gas recirculation temperature (EGRT) sensor electrical connector.
5. Remove the inlet EGRT sensor.
 - To install, tighten to 44 Nm (32 lb-ft).
6. To install, reverse the removal procedure.