

REMOVAL AND INSTALLATION

Diesel Particulate Filter Pressure Sensor

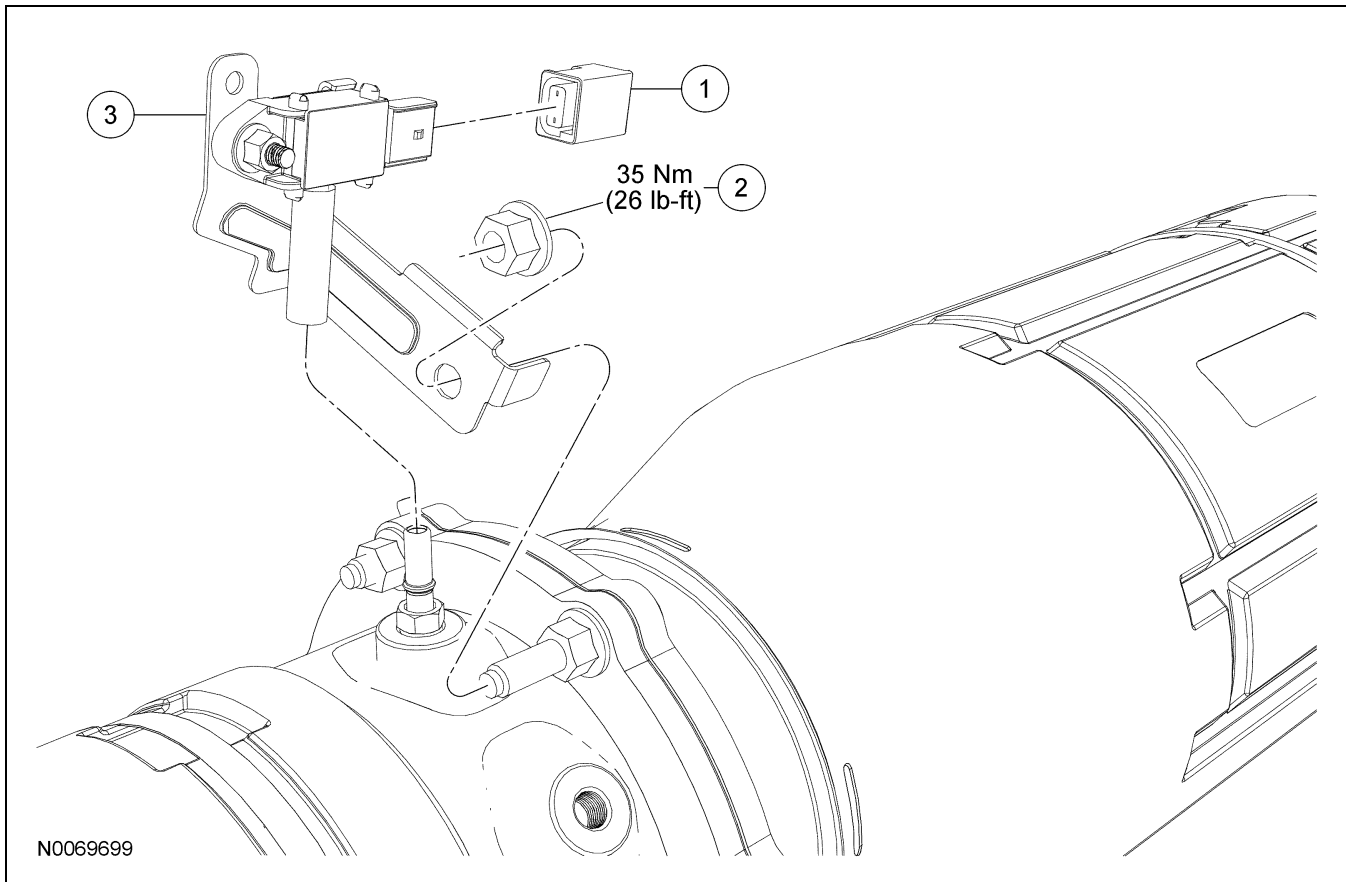

Item	Part Number	Description
1	14A464	Diesel particulate filter pressure sensor electrical connector (part of 14405)
2	W705443	Diesel particulate filter pressure sensor bracket nut
3	9H295	Diesel particulate filter pressure sensor and bracket assembly

Removal

1. With the vehicle in NEUTRAL, position it on a hoist. For additional information, refer to Section 100-02.

2. **⚠ CAUTION:** Make sure the ignition switch is in the OFF position prior to working on the electronic engine controls or the vehicle may be damaged.

Turn the ignition switch to the OFF position.

3. Disconnect the diesel particulate filter pressure sensor electrical connector.
4. Remove the diesel particulate filter pressure sensor bracket nut.

REMOVAL AND INSTALLATION (Continued)

5.  **CAUTION:** Do not attempt to remove the diesel particulate filter pressure sensor without first rotating the bracket off the stud. The hose should rotate on the oxidation catalytic converter (OC) hose fitting as the bracket is rotated. This will ease removal. If the hose will not rotate on the fitting, cut the hose vertically at the OC fitting. Do not cut the hose from the sensor. Failure to follow these instructions may damage the diesel particulate filter pressure sensor.

Rotate the diesel particulate pressure sensor and bracket assembly off the stud and remove the sensor and bracket assembly.

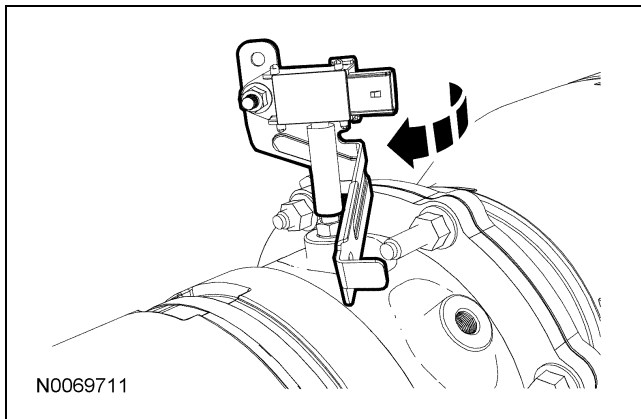
**Installation**

1. Position the diesel particulate filter pressure sensor on the OC fitting and rotate the bracket onto the stud.

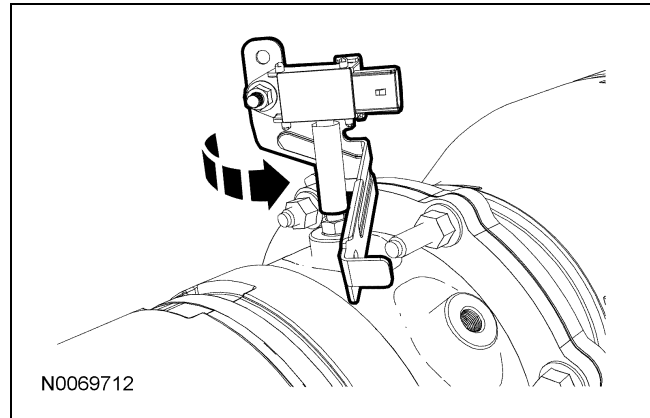

2. Install the diesel particulate filter pressure sensor bracket nut.
 - Tighten to 35 Nm (26 lb-ft).
3. Connect the diesel particulate filter sensor electrical connector.